



Power Systems Experience Center



Powering Business Worldwide

© 2017 Eaton. All Rights Reserved.



Full Scale Power System to demonstrate power systems problems and solutions



...a word about **SAFETY**

- **All equipment seen today is energized at 120V-480V**
- **ESTOPs** – Use them if necessary
- Eaton campuses are **non-smoking**



 WARNING ARC FLASH HAZARD		LABEL #
LINE SIDE of MAIN	FLASH PROTECTION BOUNDARY: 40 inches HAZARD RISK CATEGORY: 2	
INCIDENT ENERGY RANGE: 4 – 8 cal/cm ² at 24" WORKING DISTANCE		
LOAD SIDE of MAIN	FLASH PROTECTION BOUNDARY: 20 inches HAZARD RISK CATEGORY: 0	
INCIDENT ENERGY RANGE: 0 – 2 cal/cm ² at 24" WORKING DISTANCE		
PSE TQSF: ###.# Date Issued: AUGUST 2005 Study Rev.: 0		
LOCATION: BUS NAME		PROTECTIVE DEVICE: UPSTREAM DEVICE

RESTROOMS

RESTROOMS

MEETING
LOCATION

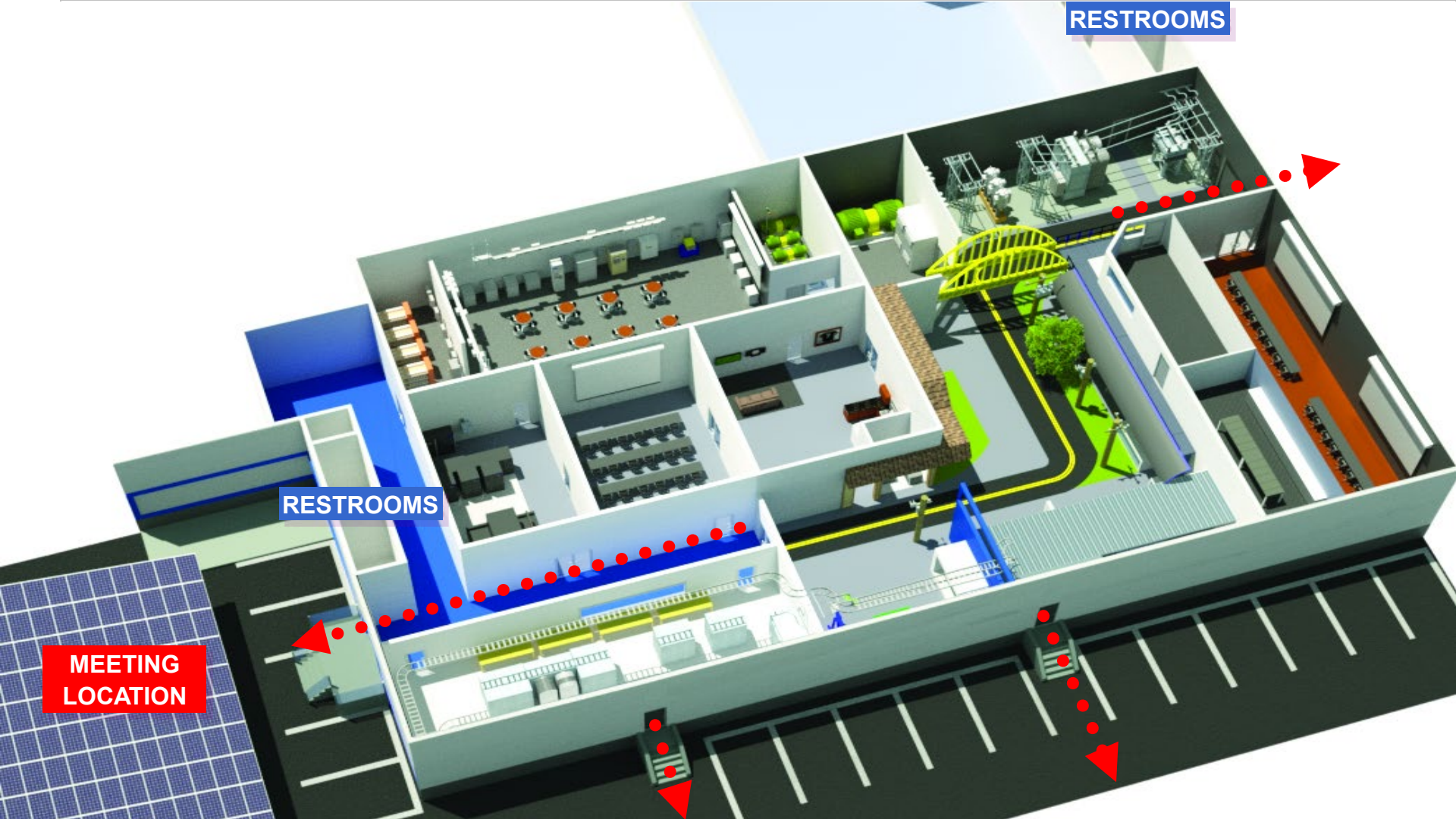

What makes the PSEC unique?

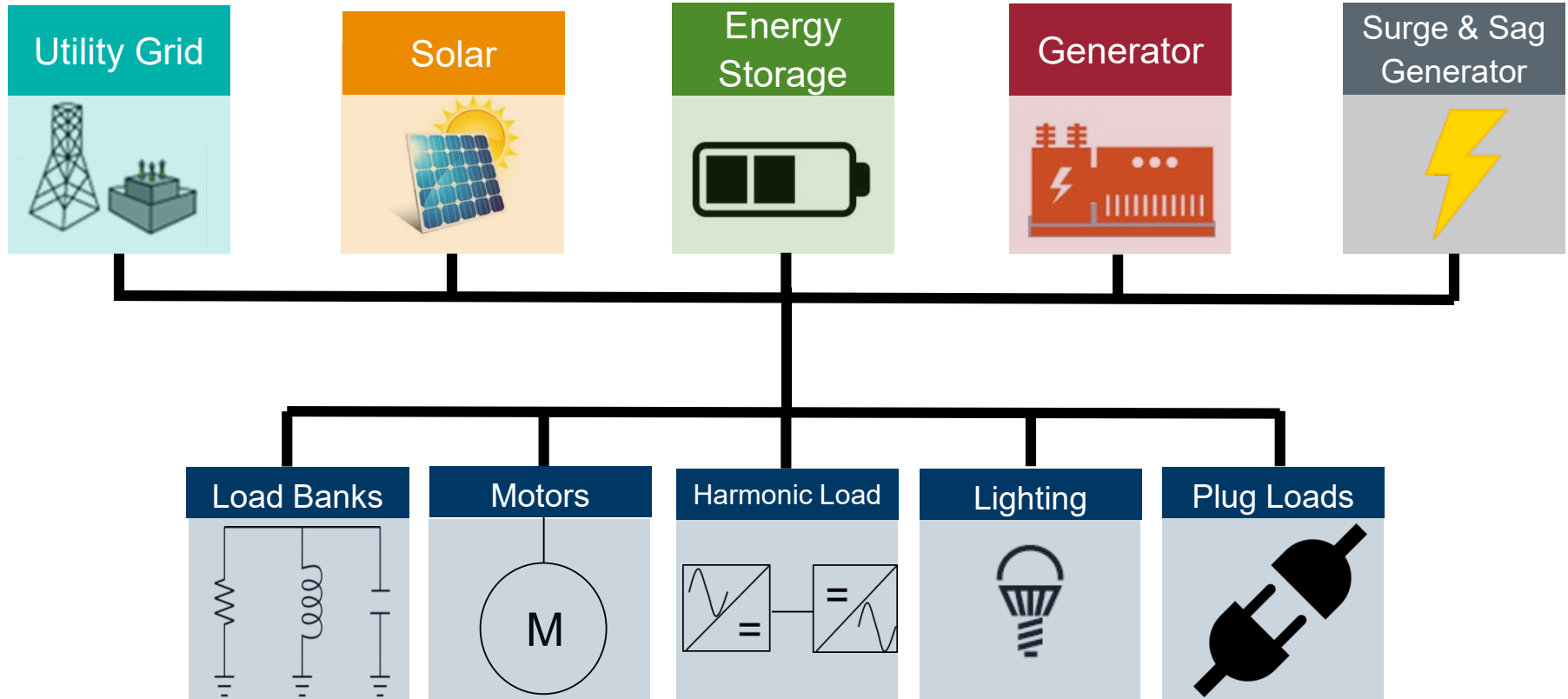



EATON
Powering Business Worldwide

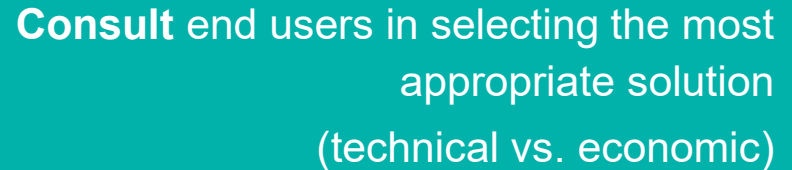

PSEC Mission: Customized Training

Tailored education of the theory behind product, solutions and industry standards through visual learning.

“Eyes on demonstrations” within various application areas bridging the gap between theory and applications for visitors



PSEC Mission: Testing

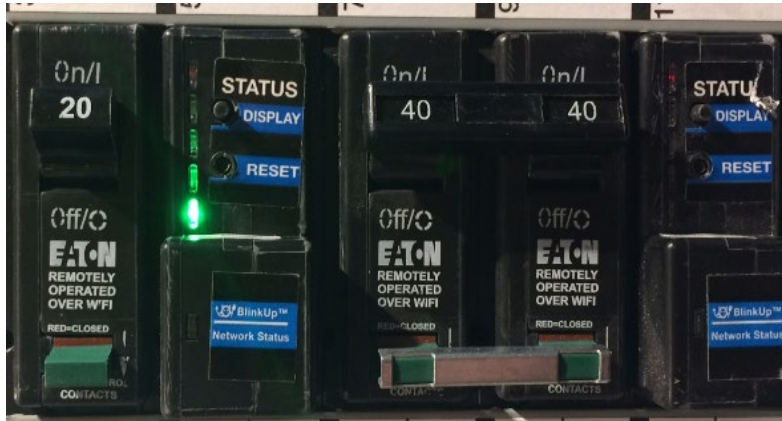

Drive research & development evaluating and testing new equipment by Eaton and others in an application environment.



Custom demonstration of technical advantages (or disadvantages) of solutions under active load and varying system conditions



Powering Business Worldwide

[Eaton.com/Experience](https://www.eaton.com/Experience)